

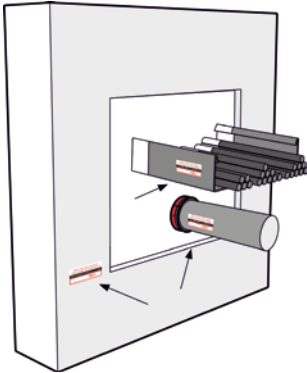

# RPI-S Sealing sticker

## APPLICATION MANUAL

Enter your company details on the RPI-S Sealing sticker.



Decide where you want to affix the RPI-S Sealing sticker. It must be clearly visible, preferably:

- on the conduit or pipe
- next to the recess on the wall, floor or ceiling

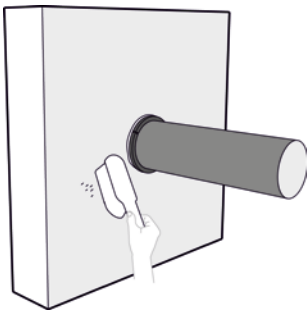

To ensure good adhesion of the RPI-S Sealing sticker, make sure the surface is clean, dry and dust-free. Do not touch the adhesive layer of the sticker while affixing it.



Remove part of the backing film from the back of the RPI-S Sealing sticker and place the sticker in the correct location. Rub the part of the sticker without the backing sheet firmly onto the surface.